



KT-RDLEDXXPS-XA-9CSF-EM4

LED RECESSED EMERGENCY DOWNLIGHT

POWER SELECT (WATTAGE) AND COLOR SELECT (CCT) ADJUSTMENT

This fixture is equipped with field-adjustable Keystone Power Select and Color Select technology.

1. Ensure power is off to the fixture.
2. Adjust dip switches to desired settings.

KT-RDLED24PS-6A-9CSF-VDIM-EM4

Wattage	CCT
24W	2700K
21W	3000K
18.5W	3500K
13W	4000K
9.5W	5000K

KT-RDLED30PS-8A-9CSF-VDIM-EM4

Wattage	CCT
30W	2700K
27W	3000K
23W	3500K
20W	4000K
16W	5000K

KT-RDLED38PS-10A-9CSF-VDIM-EM4

Wattage	CCT
38W	2700K
32W	3000K
28W	3500K
24W	4000K
20W	5000K

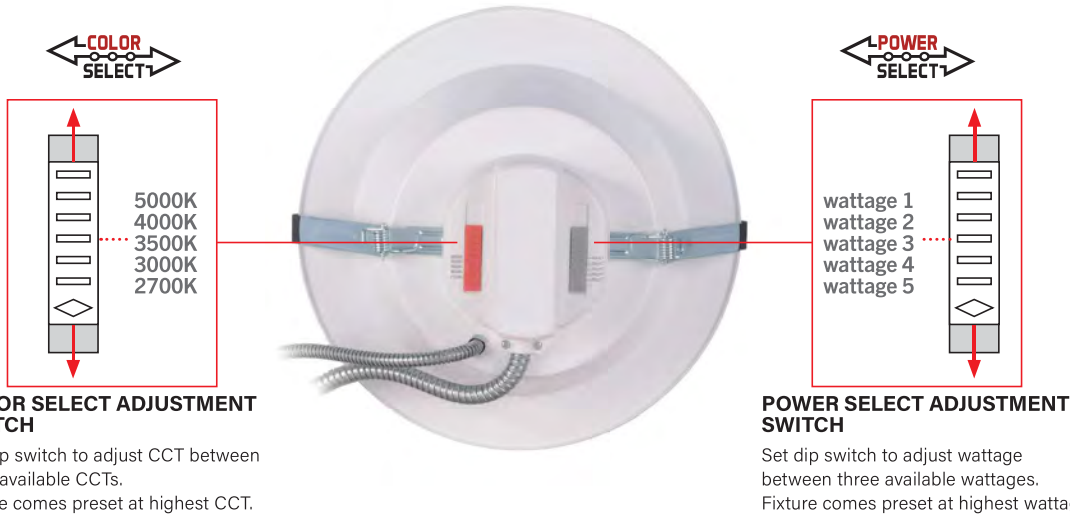

WIRING SPECIFICATIONS

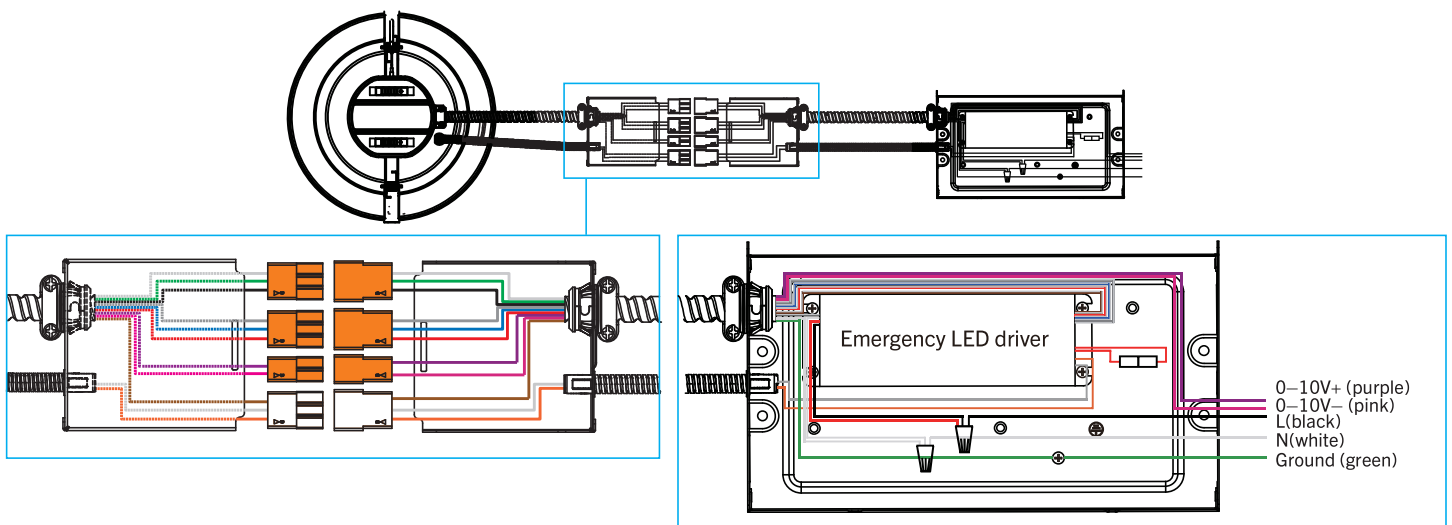

Note: Install in accordance with National Electric Code. Emergency pack and fixture driver must be on the same branch circuit. Ensure hot/live lead going to the black wire on the emergency LED driver is unswitched. When used with switched fixtures, the emergency pack must be wired ahead of the switch.

KT-RDLEDXXPS-XA-9CSF-EM4 LED RECESSED EMERGENCY DOWNLIGHT

INSTALLATION INSTRUCTIONS*

1. Shut off power at the source of the fixture housing into which you are installing fixture.

If retrofit, remove existing trim, CFL/ incandescent bulb, and ballast/ emergency ballast.

Note: Follow all federal and local regulations when disposing of lamps and removed components.

2. Use template to cut appropriate sized hole in ceiling for fixture.

If retrofit, measure existing ceiling opening to ensure that the edge of the luminaire will cover the entire opening and still sit firmly in the ceiling (see *Dimensions* on page 2).

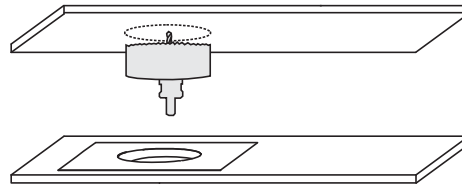

3. Select desired Wattage and CCT using adjustment switches on fixture (see *Power Select (Wattage) and Color Select (CCT) Adjustment* on page 3).

4. Attach safety clip to structural point above plenum.

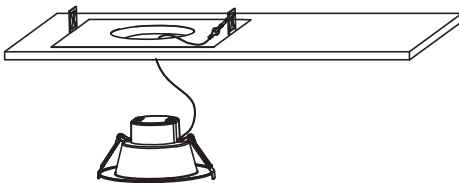

5. Insert J-box with EM pack into ceiling and wire to power source. Install in accordance with local and national codes. (See *Wiring Diagram* on page 3). Close J-box cover when done.

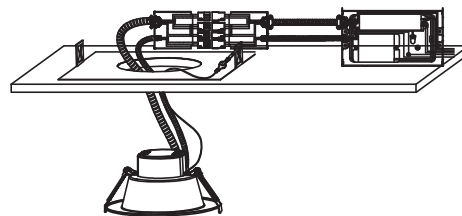

6. Push connectors from downlight together with connectors from emergency pack J-box. Note that each connector is keyed to fit only with its corresponding counterpart. Snap connector box together to close.

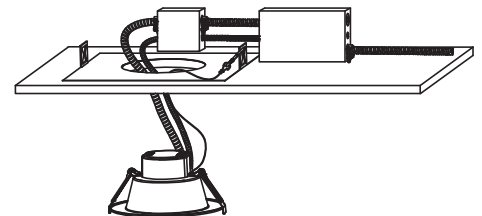

7. Squeeze the two housing clips so they are in an upright position and then insert lamp into housing.

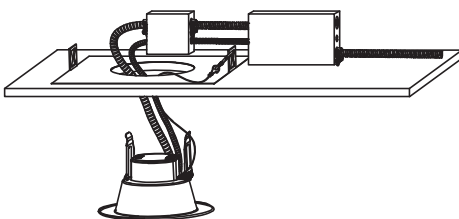

8. Once lamp is inside housing, release housing clips and continue to push lamp into housing until securely fixed and flush with ceiling. Restore power.

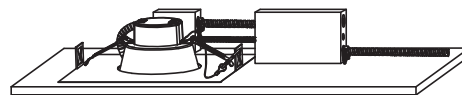

* Keystone offers an optional new-construction plate for both new joist and T-grid installations. See *Optional Accessories* (sold separately) on page 6.



ADVANTA_{EMRG}

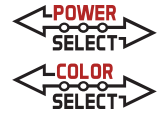

KT-RDLEDXXPS-XA-9CSF-EM4 LED RECESSED EMERGENCY DOWNLIGHT

OPERATION

NORMAL MODE

- AC power is present.
- The AC driver operates the LED load as designed.
- The emergency pack is charging in a standby mode.
- The test button will be lit, showing that the battery is charging.
- When battery is fully charged, test button will remain lit.

EMERGENCY MODE

- When the AC power goes out, the emergency pack detects the power outage and automatically switches to the emergency mode.
- The LED load is illuminated for a minimum of 90 minutes.
- The test button will not be lit.
- When AC power is restored, the emergency pack switches back to normal mode and starts re-charging.
- If emergency driver detects battery failure due to problems such as bad contact or charging issues, the test button will not be lit.
- Please contact a qualified electrician for inspection.

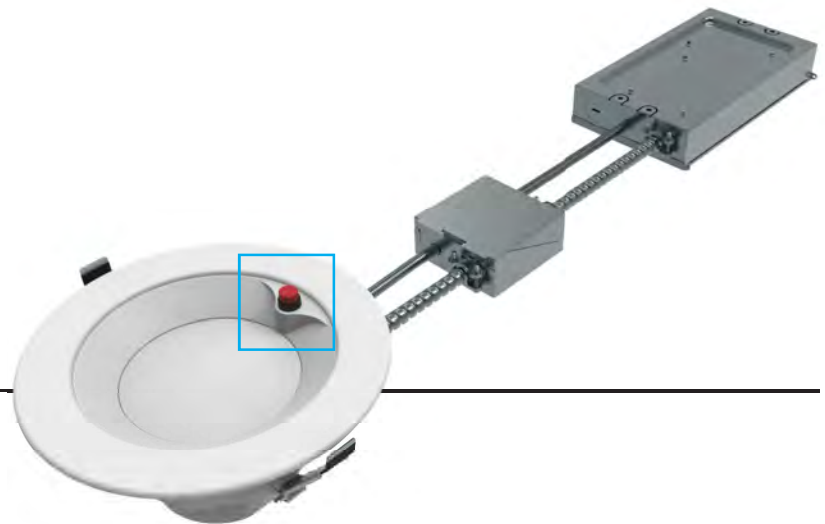

TESTING PROCEDURES

1. Press the test button to cut the power to the AC driver and switch the system to emergency mode.
2. Release the test button to return to normal mode.
3. Switch off the circuit breaker to simulate a full power outage.
4. For initial testing, allow the unit to charge for approximately one (1) hour, then conduct a short discharge test.
5. Allow a 24-hour charge before conducting a one-hour test.

ROUTINE TESTING SCHEDULE

NFPA 101, Life Safety Code outlines the following schedule:

Monthly

1. Ensure that the test button light is illuminated.
2. Conduct a 30-second discharge test by depressing the test button.
3. The LED load should operate at reduced output.

Annually

1. Ensure that the test button is illuminated.
2. Conduct a full 90-minute discharge test.
3. The unit should operate as intended for the duration of the test.

"Written records of the testing shall be kept by the owner for inspection by the authority having jurisdiction."