

KT-EM-TP2-XXWL-SU

EMERGENCY LIGHT

DESCRIPTION

Emergency Light | Dual Heads |
White or Black Finish | 6500K White Light | Surface Mount |
Battery Backup | Built-in Test Switch | 120-277V Input

APPLICATION

UL 924 Compliant Emergency Light Rated for Damp Locations. Provides 90 Minutes of Emergency Power.



PRODUCT FEATURES

- 6500K White Light Dual Heads
- Surface Mount - Back
- Integrated Backup Battery - NiMH - 1000mAh
- 90 Minutes of Emergency Power
- Integrated Test Switch & Charge Indicator
- Thermoplastic Housing - UL 94 5VA Flame Rating
- Ambient Operating Temperature: 0°C/32°F to 40°C/104°F
- UL Certified for Damp Locations
- Universal J-Box Mounting Pattern

PERFORMANCE SPECIFICATIONS

Catalog Number	Input Voltage	Input Power	CCT	Lumens	Housing Color	Mounting	Battery Type	Battery Capacity	Recharge Time	Remote Capable
KT-EM-TP2-WHWL-SU	120-277V	1.5W	6500K	160	White	Surface: Back Mount	Nickel-Metal Hydride	1000mAh	24 Hours	No
KT-EM-TP2-BLWL-SU					Black					

* See Ordering Information and Catalog Number Breakdown for more details.

PHYSICAL SPECIFICATIONS

Weight	
Fixture Weight	Carton Weight
0.7 lbs	10.7 lbs

KT-EM-TP2-XXWL-SU
EMERGENCY LIGHT

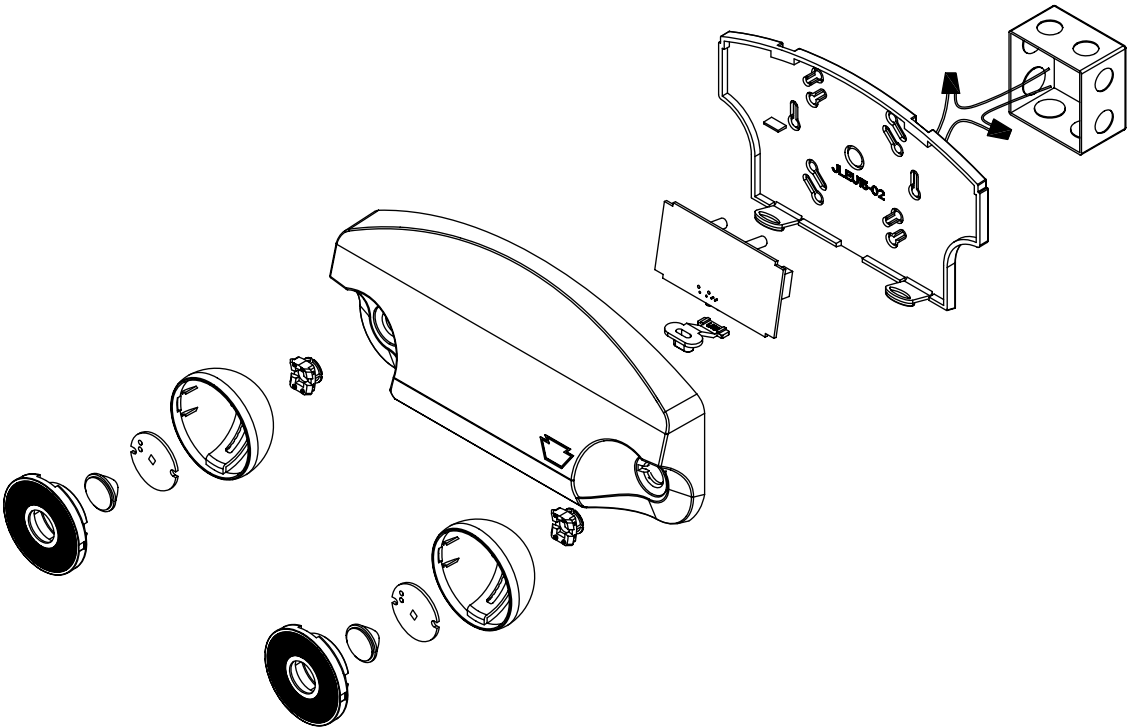

SPACING GUIDELINES

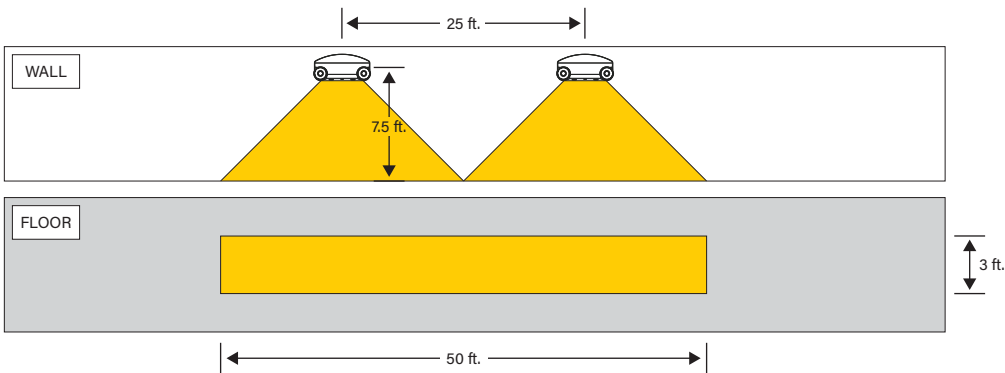

Multiple Unit Spacing	
Room Description	8' x 12' Hallway
Head Orientation	30° Rotation, 40° Tilt
Path of Egress	3' Wide
Illumination	1fc average, 0.1fc minimum

*Spacing guidelines provided are for general reference only. Actual performance will vary based on each installations unique dimensions, wall colors, floor type, and other factors. Please contact lightinglayouts@keystonetech.com for detailed layout assistance needs.



SMART//SAFE®

KT-EM-TP2-XXWL-SU

EMERGENCY LIGHT

ORDERING INFORMATION

Catalog Number	Finish	UPC	Easy Code
KT-EM-TP2-WHWL-SU	White	843654165110	ECR-78
KT-EM-TP2-BLWL-SU	Black	843654165127	DBG-03

CATALOG NUMBER BREAKDOWN

KT-EM-TP2-XXWL-SU

1	2	3	4	5	6	7	8
---	---	---	---	---	---	---	---

- 1 Keystone Technologies
- 2 Emergency Light
- 3 Thermo Plastic
- 4 Form Factor 2
- 5 Housing Color
- 6 Light Color
- 7 Mounting
- 8 Input Voltage

5 Housing Color

WH	White
BL	Black

6 Light Color

WL	White Light
----	-------------

7 Mounting

S	Surface Mount
---	---------------

8 Input Voltage

U	120-277V
---	----------