

PROJECT NAME: _____ CAT. #: _____
 NOTES: _____ FIXTURE SCHEDULE: _____

Control Node Photocell



CN-RDPCB



CN-RTPCT

Features

- Simple “Plug-and-Play” Connection - Easy to install in the field with pre-installed USB-C receptacle in controls ready fixtures
- Available in two form factors for Outdoor fixtures - check below link to determine fixture compatibility (<https://www.maxlite.com/cmax/>)
- Includes locking screw to resist vandalism and withstand vibration (Round PC requires M1.5 Allen wrench, Rectangular requires M2.5 Allen wrench)
- Control Technology: Photoelectric
- 5 Year Warranty

Ordering Information

MODEL NUMBER	ORDER CODE	DESCRIPTION
CN-RDPCB	105569	CN-RD= Photocell Node Round PC, Bronze, IP66
CN-RTPCT	105568	CN-RT= Photocell Node Rectangular PC, Translucent

Specifications

	CN-RDPCB	CN-RTPCT
OPERATING VOLTAGE	12-20VDC	
OPERATING CURRENT	max 8mA	
SENSOR TECHNOLOGY	Photoelectric	
PHOTOELECTRIC CONTROL	ON/OFF @ 5fc / 50lux	
CONTROL OUTPUT	0-10V	
CONNECTOR INTERFACE	USB-C	
ENVIRONMENT	IP66, Wet Location	Damp Location
CERTIFICATION/STANDARD	cULus Listed E511069, California Title 20 Compliant, FCC Part 15 Subpart B Class A	
OPERATING TEMPERATURE	-40°F to 130°F / -40°C to 55°C	
OVERALL DIMENSIONS	1.44" x 1" / 36.6mm x 25.4mm	1.91" X 0.8" X 0.57" / 48.5mm X 20.5mm X 14.6mm
COLOR	White, Bronze	Translucent
WEIGHT	0.48oz/13.8g	0.32oz/9g

Control Node Photocell

Product Dimensions

CN-RDPCB TOP

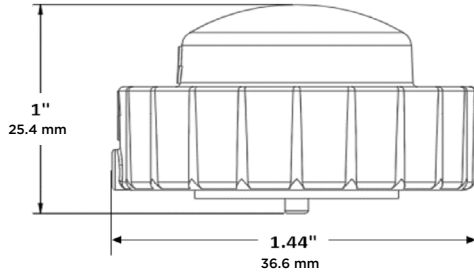

*Lock screw requires M1.5 Allen wrench

CN-RTPCT TOP

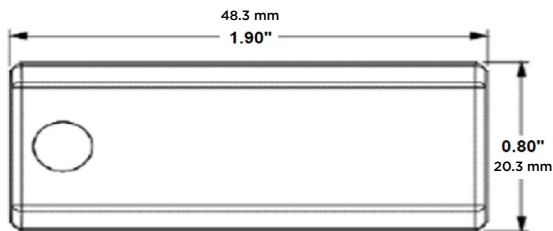

*Lock screw requires M2.5 Allen wrench

CN-RTPCT SIDE

